



**How to configure
Caribe Handheld Devices (PL-
04L , PL-40L and PL-60L) for
MobileNAV Android application**



1. CONFIGURE CARIBE PL-04L , PL-40L HANDHELD DEVICE

1.1 Device configuration

- Launch **Scanner** application (or **Scan Settings** on newer models)
- Go to **Settings** tab, and change the **Output mode** (or **Input Model**) to **Broadcast mode**

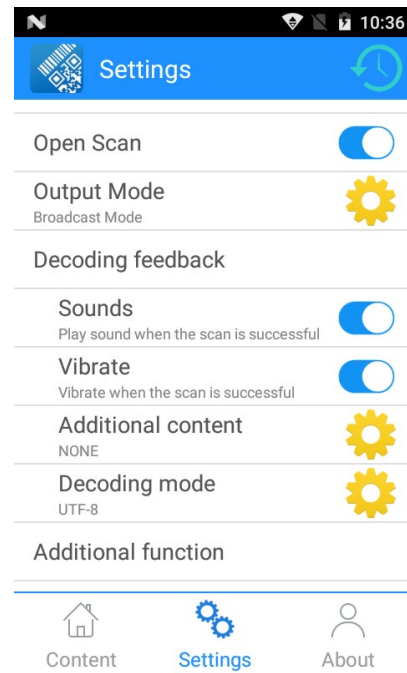
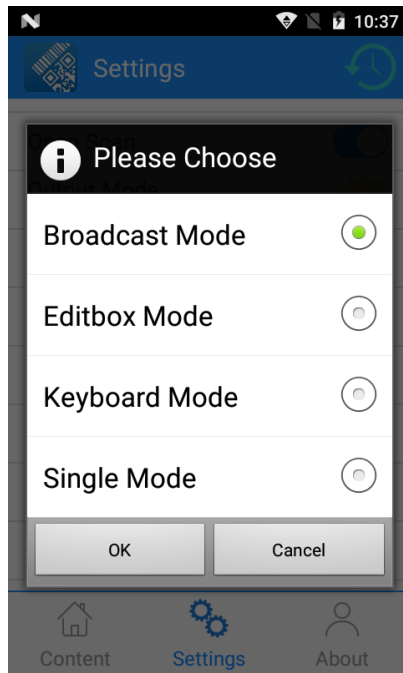

- **Additional content** setting should be **NONE**
- **Append prefix** and **Append suffix** should be empty.

1.2 MobileNAV app configuration

- Launch **MobileNAV** application
- Log into online or offline
- Click on main menu (MobileNAV icon on the top left)
 - a. Select **Settings**
 - b. Barcode mode: **Device-specific**
 - c. click on **Configure...** button
 - i. Intent action: **scan.rcv.message**
 - ii. Intent category: (leave empty)
 - iii. Data id: **barcode**

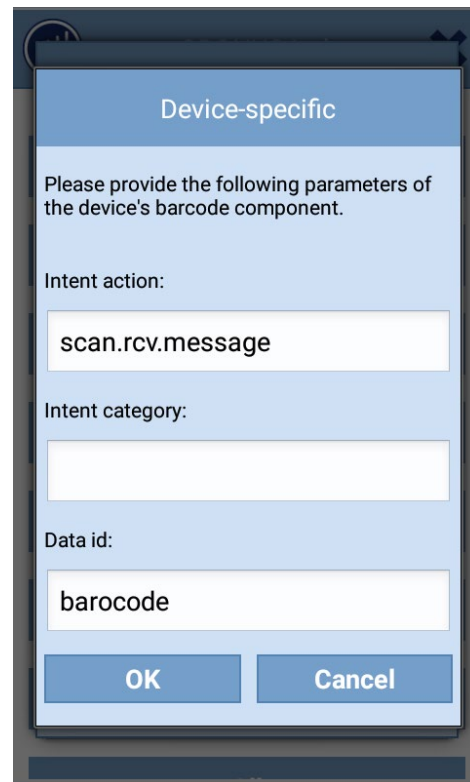
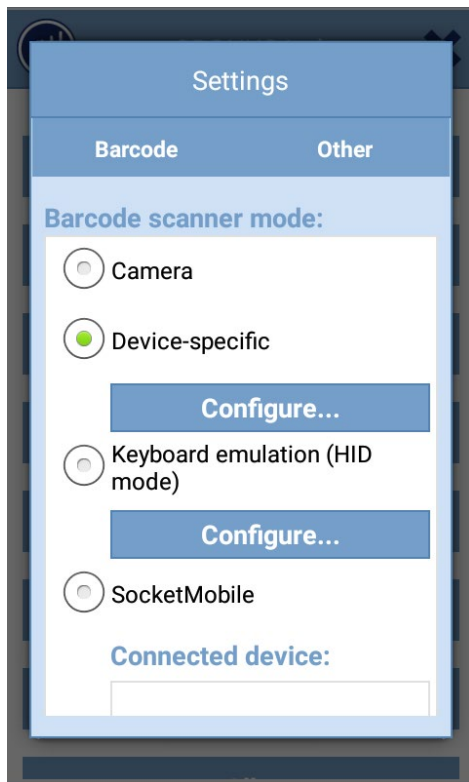

- If the previous setting would not work on newer models, then try it like this
 - a. Select **Settings**
 - b. Barcode mode: **Device-specific**
 - c. click on **Configure...** button
 - i. Intent action: **com.action.SCAN_RESULT**
 - ii. Intent category: (leave empty)
 - iii. Data id: **scanContext**

2. CONFIGURE CARIBE PL-60L HANDHELD DEVICE

2.1 Device configuration

- Launch Barcode Service application

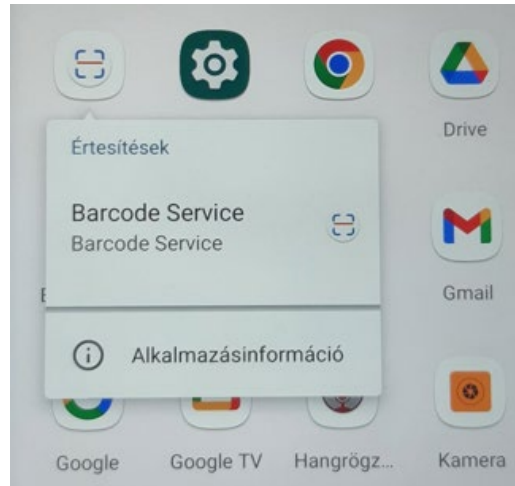

- Click on Function, and change the Process mode to BroadcastReceiver mode

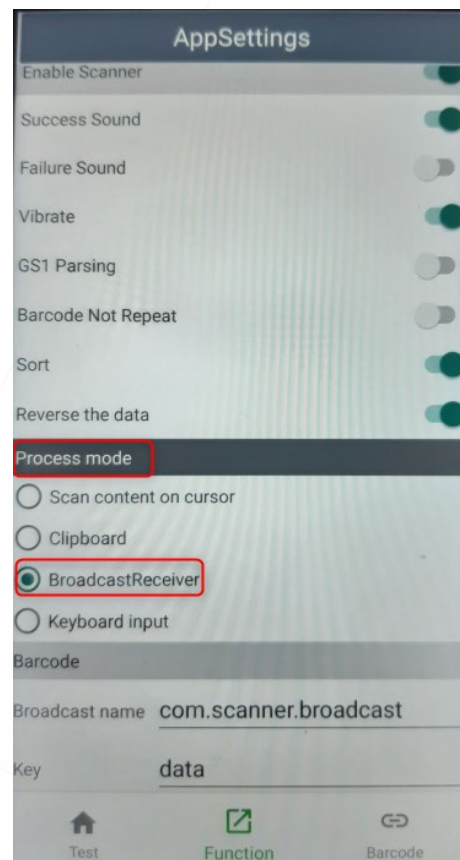



2.2 MobileNAV app configuration

- Launch **MobileNAV** application
- Log into online or offline
- Click on main menu (the hamburger menu on the top right / from version 10)
 - a. Select App settings > **Scanning**
 - b. Barcode mode: **Device-specific**
 - c. click on **Configure...** button
 - i. Intent action: **com.scanner.broadcast**
 - ii. Intent category: (leave empty)
 - iii. Data id: **data**