

## How to configure Motorola-Zebra Touch Computers (MC2200,MC3200, MC3300, MC40, MC40-HC, TC21,TC55, TC70, TC75, TC8000, ET1, ET50, ET55) for MobileNAV Android application

---

### Configure Motorola-Zebra Touch Computer

- Launch **DataWedge** application
- The **DataWedge Profiles** screen appears

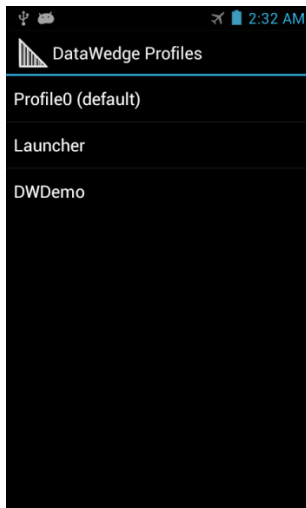

- Use preferred profile e.g. **Profile0 (default)** or create your **own**
- To configure the **selected profile**, touch the profile name
  - The **Profile** configuration screen appears.

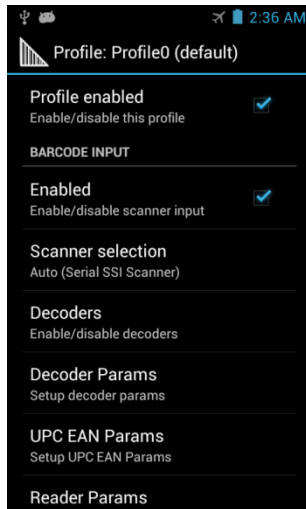

- Make sure Profile enabled is checked
- **BARCODE INPUT** section
  - Enabled: **checked**
  - Scanner selection: **Auto** or **2D Imager**
  - Decoders: enable decoders based on your barcode types (e.g.: Code 128)
- ...
- Keystroke Output section
  - Enabled: **false**
- **Intent Output** section
  - Enabled: **checked**
  - Intent action: **hu.multisoft.mobilenav.barcode**
  - Intent category: leave **[EMPTY]**
  - Intent delivery: **Broadcast intent**
  - Advanced data formatting: based on your custom format
  - Basic data formatting: based on your custom format
- **IP Output** section
  - Enabled: **false**
- **Other options leave unmodified.**
- If you created your own profile
  - Use the **Applications** option to associate **MobileNAV** with this profile.
  - Touch **Associated apps**. A list of applications/activities associated with the profile displays. Initially the list does not contain any applications/activities.
  - Touch  > **New app/activity**.
  - The **Select application** menu appears.
    - **hu.multisoft.mobilenav**
    - \*

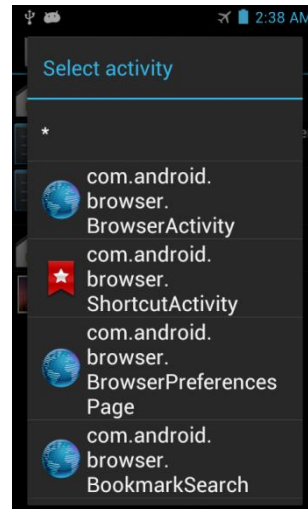
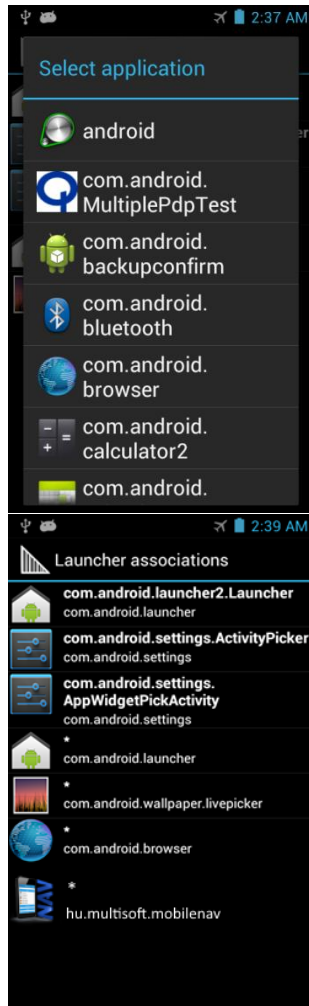

## Configure Mobilenav

- Launch **MobileNAV** application
- Log into online or offline
- Click on main menu(MobileNAV icon on the top left)
  - a. Select **Settings**
  - b. Barcode mode: **device-specific**
  - c. click on **Configure...** button
    - i. Intent action: **hu.multisoft.mobilenav.barcode** (same as in DataWedge settings)
    - ii. Intent category: (leave empty)
    - iii. Data id:
      1. First try to enter

**com.motorolasolutions.emdk.datawedge.data\_string**

2. If that does not work, you can also try

**com.symbol.emdk.datawedge.data\_string**

3. If that does not work, you can also try

**com.symbol.datawedge.data\_string**

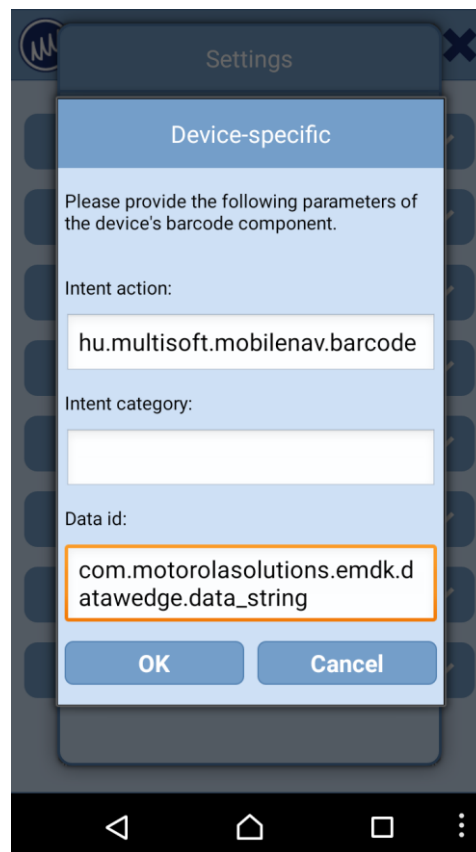
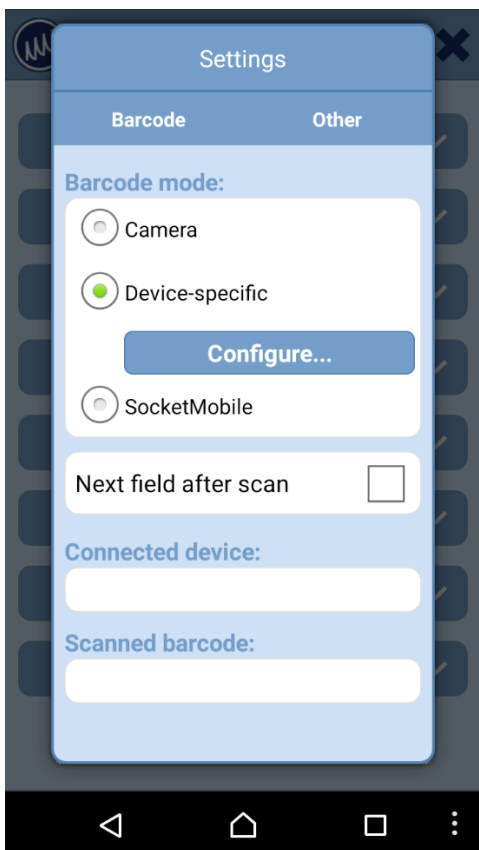

For more information and option about DataWedge application visit the link below:

<https://developer.motorolasolutions.com/docs/DOC-1928#atawedgeconfiguration>